

1

## INCLUDED IN STANDARD MODEL PRICE

- 1 module (9m x 3,5m)
- Completely Furnished – per floor plan – see technical specifications for details\*
- Delivery and Installation in continental Portugal
- VAT
- Architectural & Specialty Projects Preparation
- Follow-up throughout the licensing/permitting process
- Up to A+ Energy Certification
- 150L Solar Powered Water Heater
- Wood cladding for chassis
- Cement Foundation
- 2,5 meter ceiling height
  
- **Living Room/Dining Room**
  - Sofa Bed
  - Side Table
  - Custom TV Table
  - Built-in wardrobe
  - Dining Room Table w/ 2 chairs
  - Pre-installation for Air Conditioning
- **Kitchen**
  - Upper/Lower cabinets
  - Electric hob/Exhaust hood/Oven (cooker)
  - Under-counter refrigerator
- **1 WC**
  - Vanity w/mirror
  - Stylish toilet
  - Bath Tub
  - Bidet
- **Flooring**
  - Laminate floor throughout
  - Ceramic tile in WCs
- **Windows & Doors per floorplan**
  - 90cm entrance door (in frosted glass)
  - (2) 120x100 sliding windows w/electric shutters
  - (1) 50x100 tilting Window

\* Standard items included in our price. Other materials, colours, equipment and different options may be available for the same price, however, in these instances we will provide you with a quotation.  
Standard Model Price subject to change without notice.

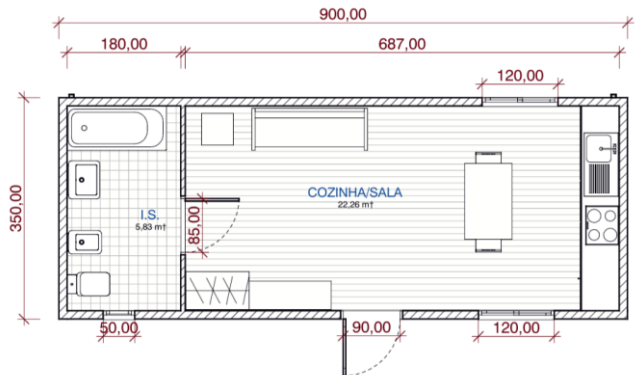

2

## NOT INCLUDED IN STANDARD MODEL PRICE BUT NECESSARY FOR PROJECT COMPLETION\*\*

- Site/Land Preparation
  - Clearing of Land
  - Preparation for cement Foundation
  - Trench digging for external networks/connection to external networks
  - Burying of tanks for water deposits and septic systems
- Installation of External Electricity Network
- Installation of External Water Network
- Installation of External Sewage Network
- Crane Unloading Service
- Fees required by official entities responsible for licensing & permits
- Use License

**\*\* KITUR CAN MANAGE THESE ASPECTS OF THE PROJECT FOR YOU. ALL PRICING FOR THESE ITEMS ARE QUOTED ON A CASE BY CASE BASIS, AS THE COSTS OF THESE ITEMS ARE SOLELY DEPENDENT ON THE LAND WHERE YOUR HOUSE WILL BE INSTALLED.**

3

## ADDITIONAL FEATURE UPGRADES NOT INCLUDED IN STANDARD MODEL PRICE\*\*\*

- Terraces or other outside structures
- Interior or exterior finishings not according to the General Specifications and Standard Model Definitions.

\*\*\* Pricing provided upon request